

DIS. COD. 63.9509.00

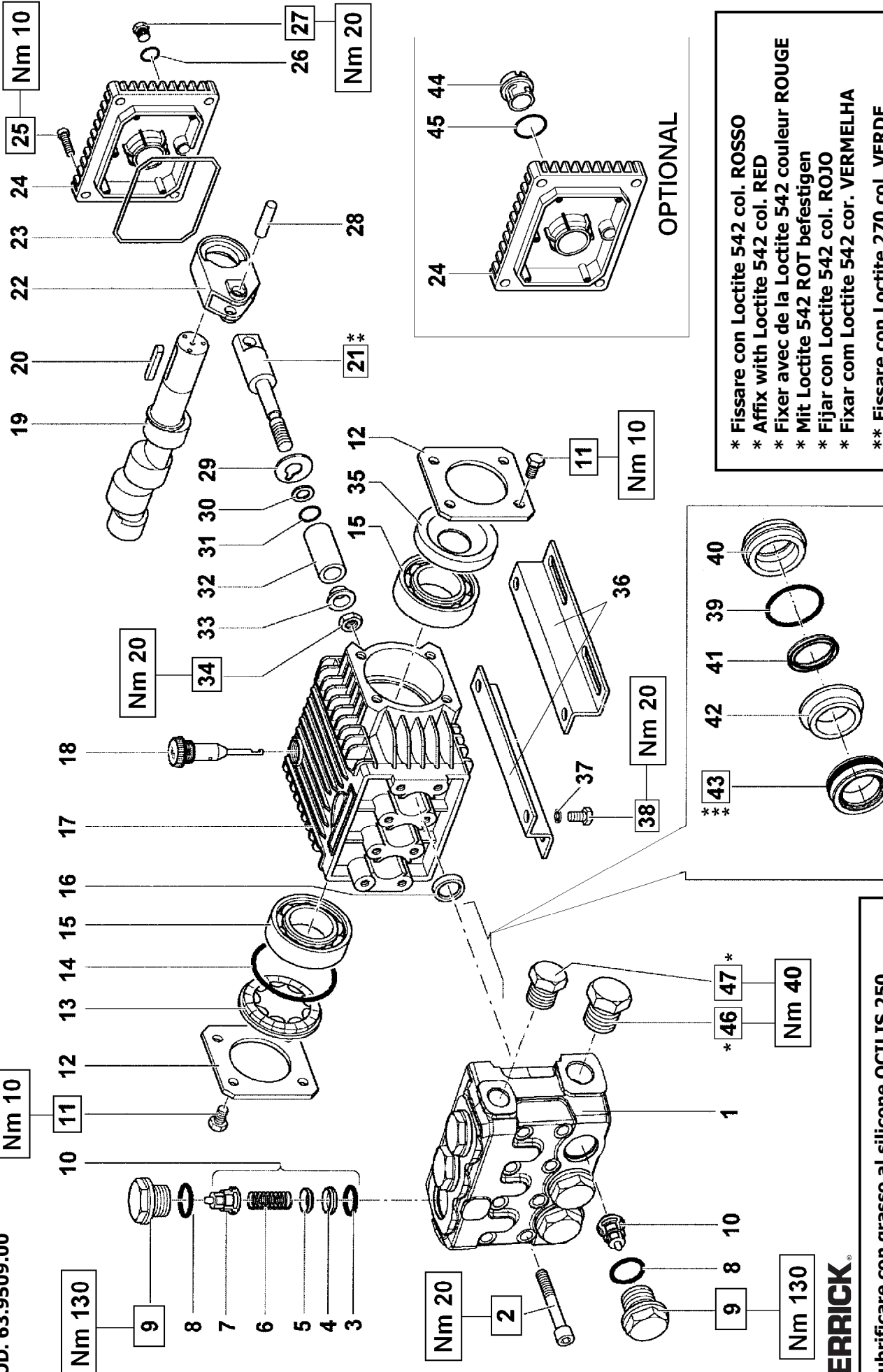

OPTIONAL

- * Fissare con Loctite 542 col. ROSSO
- * Affix with Loctite 542 col. RED
- * Fixer avec de la Loctite 542 couleur ROUGE
- * Mit Loctite 542 ROT befestigen
- * Fijar con Loctite 542 col. ROJO
- * Fixar com Loctite 542 cor. VERMELHA
- ** Fissare con Loctite 270 col. VERDE
- ** Affix with Loctite 270 col. GREEN
- ** Fixer avec de la Loctite 270 couleur VERT
- ** Mit Loctite 270 GRÜN befestigen
- ** Fijar con Loctite 270 col. VERDE
- ** Fixar com Loctite 270 cor. VERDE

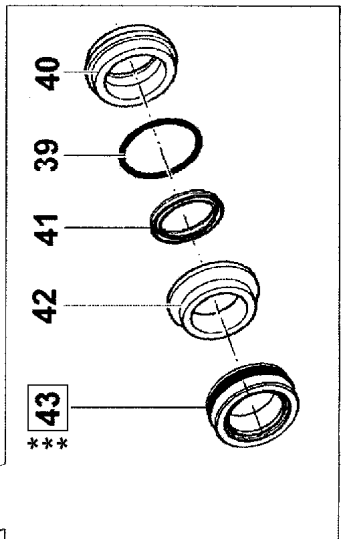

SERIE 63

SS



- *** Lubrificare con grasso al silicone OCILIS 250
- *** To lubricate with silicon grease OCILIS 250
- *** Lubrifier avec gras à la silicone OCILIS 250
- *** Sich mit fett zum Silikon OCILIS 250 schmieren
- *** Para lubricar con la grasa al silicón OCILIS 250
- *** Para lubrificar com a graxa ao silicone OCILIS 250



SSE1505 – SSE1507
SSE1509 – SSE1411
SSE1413 – SSE1414
SSU1509 – SSU1511
SSU1413 – SSU1415

PISTONE – PISTON Ø15

SSE1505 – SSE1507
SSE1509 – SSU1509
SSU1511

PISTONE – PISTON Ø18

SSE1411 – SSE1413
SSE1414 – SSU1413
SSU1415

| POS | COD. | DESCRIZIONE – DESCRIPTION - KIT | NR |
|-----|--------------------------|--|--------|
| 1 | 63.1216.36 63.1219.36 | Testata Ø 15 - INOX Testata Ø 18 - INOX | 1 1 |
| 2 | 99.3193.00 | Vite M8x65 UNI 5931 - INOX | 8 |
| 3 | 90.3841.00 | OR Ø 17.13x2.62 (3068) | 192 |
| 4 | 36.2036.66 | Sede valvola - INOX | 192 |
| 5 | 36.2001.76 | Valvola | 192 |
| 6 | 94.7373.00 | Molla Ø 9.4x14.8 - INOX | 192 |
| 7 | 36.2025.51 | Guida valvola | 192 |
| 8 | 90.3847.00 | OR Ø 20.24x2.62 (3081) – 90 Sh. | 6 |
| 9 | 98.2229.00 | Tappo M24x1.5x17 - INOX | 6 |
| 10 | 36.7130.01 | Gruppo valvola asp./man. – INOX | 192 |
| 11 | 99.1808.00 | Vite M6x10 UNI 5739 – INOX | 8 |
| 12 | 63.1500.76 | Coperchio laterale - INOX | 2 |
| 13 | 44.2118.01 | Distanziale con indicatore | 1 |
| 14 | 90.4097.00 | OR Ø 55.56x3.53 (159) | 1 |

KIT RICAMBI – SPARE KITS

| KIT Nr. | KIT 159 | KIT 192 | PISTONE – PISTON Ø 15 | | PISTONE – PISTON Ø 18 | |
|---|---------|----------------------------|-----------------------|--------------------------|-----------------------|--------------------------|
| | | | KIT 214 | KIT 215 | KIT 204 | KIT 216 |
| Posizioni include Positions included | 16 | 3 - 4 5 - 6 - 7 (10) | 41 - 43 | 39 - 40 41 - 42 43 | 41 - 43 | 39 - 40 41 - 42 43 |
| Nr. Pcs. | 3 | 6 | 3 | 1 | 3 | 1 |

| POS | COD. | DESCRIZIONE – DESCRIPTION – KIT | NR |
|-----|------------|---|-----|
| 15 | 91.8331.00 | Cuscinetto a sfere 6305 | 2 |
| 16 | 90.1595.00 | Anello rad. Ø 18x26x6 | 159 |
| 17 | 63.0100.22 | Carter pompa | 1 |
| 18 | 98.2103.00 | Tappo carico olio G 3/8" | 1 |
| 19 | 63.0212.65 | Albero - SSE1507 – SSE1411 – SSU1509 SSU1413 | 1 |
| | 63.0216.65 | Albero – SSE1509 – SSE1413 – SSU1511 SSU1416 | 1 |
| | 63.0218.65 | Albero – SSE1414 | 1 |
| | 63.0205.65 | Albero – SSE1505 | 1 |
| 20 | 91.4892.00 | Linguetta | 1 |
| 21 | 63.0501.66 | Guida pistone - INOX | 3 |
| 22 | 63.0300.22 | Biella | 3 |
| 23 | 90.3920.00 | OR Ø 101.27x2.62 (3400) | 1 |
| 24 | 63.1600.22 | Coperchio posteriore - OPTIONAL | 1 |
| | 63.1601.22 | Coperchio posteriore | 1 |
| 25 | 99.1838.00 | Vite M6x14 UNI 5931 – INOX | 4 |
| 26 | 90.3585.00 | OR Ø 10.82x1.78 (2043) | 1 |
| 27 | 98.2040.00 | Tappo G 1/4"x9 - INOX | 1 |
| 28 | 97.7335.00 | Spinotto Ø 9x27.5 | 3 |
| 29 | 96.7076.00 | Rosetta Ø 9x25x0.5 - INOX | 3 |
| 30 | 90.5022.00 | Anello antiest. Ø 6.2x9x1.5 | 3 |
| 31 | 90.3573.00 | OR Ø 5.28x1.78 (2021) | 3 |
| 32 | 52.0400.09 | Pistone Ø 15 | 3 |
| | 44.0401.09 | Pistone Ø 18 | 3 |
| 33 | 63.2115.66 | Rosetta Ø 8 con collare – INOX | 3 |

| POS | COD. | DESCRIZIONE – DESCRIPTION - KIT | NR |
|-----|------------|-----------------------------------|---------|
| 34 | 92.2215.00 | Dado M8 - INOX | 3 |
| 35 | 90.1641.00 | Anello rad. Ø 25x62x10 | 1 |
| 36 | 50.2000.74 | Piedino | 2 |
| 37 | 96.7016.00 | Rosetta Ø 8.4 UNI 1751 – Zinc. | 4 |
| 38 | 99.3037.00 | Vite M8x16 UNI 5739 – Zinc. | 4 |
| 39 | 90.3608.00 | OR Ø 28.3x1.78 (2112) | 215-216 |
| 40 | 63.0806.66 | Anello di fondo Ø 15 - INOX | 215 |
| | 63.0807.66 | Anello di fondo Ø 18 - INOX | 216 |
| 41 | 90.2150.00 | Anello ten. alt. Ø 15x19.5 LP | 214-215 |
| | 90.2200.00 | Anello ten. alt. Ø 18x22.5 LP | 204-216 |
| 42 | 63.2164.66 | Anello intermedio Ø 15 - INOX | 215 |
| | 63.2165.66 | Anello intermedio Ø 18 - INOX | 216 |
| 43 | 90.2160.00 | Anello ten. alt. Ø 15x24x8.5 HP | 214-215 |
| | 90.2210.00 | Anello ten. alt. Ø 18x28x10 HP | 204-216 |
| 44 | 63.2100.51 | Spia livello olio – OPTIONAL | 1 |
| 45 | 90.4051.00 | OR Ø 26.58x3.53 (4106) – OPTIONAL | 1 |
| 46 | 98.2180.00 | Tappo G 1/2"x10 - INOX | 1 |
| 47 | 98.2100.66 | Tappo G 3/8"x13 - INOX | 1 |

VERSION B (for electric motors IEC 100-112 B14)

SSE1505 – SSE1507 – SSE1509
SSE1411 – SSE1413 – SSE1414

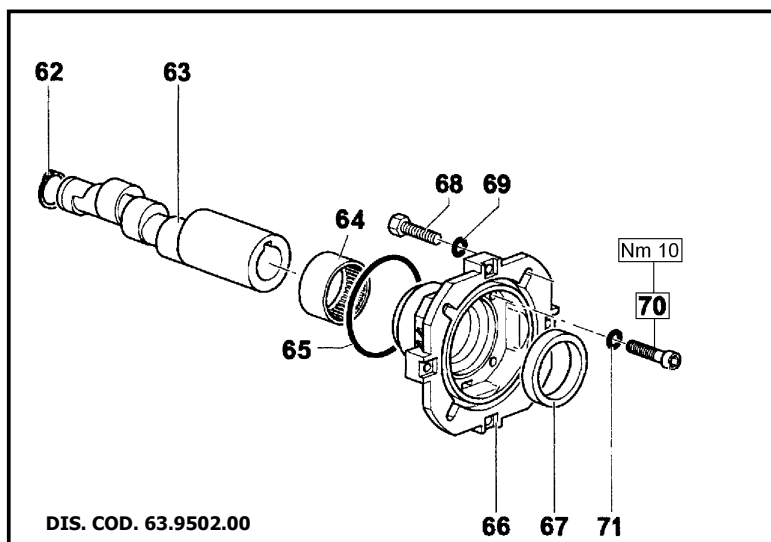

| POS | COD. | DESCRIZIONE - DESCRIPTION | NR |
|-----|------------|-------------------------------|----|
| 62 | 90.0635.00 | Anello di fermo Ø 25 UNI 7435 | 1 |
| 63 | 63.0245.65 | Albero – SSE1505 | 1 |
| | 63.0252.65 | Albero – SSE1507 – SSE1411 | 1 |
| | 63.0256.65 | Albero – SSE1509 – SSE1413 | 1 |
| | 63.0295.65 | Albero – SSE1414 | 1 |
| 64 | 91.8568.00 | Boccola a rullini | 1 |
| 65 | 90.4097.00 | OR Ø 55.56x3.56 (159) | 1 |
| 66 | 10.0494.22 | Flangia per motore elettrico | 1 |
| 67 | 90.1690.00 | Anello rad. Ø 45x62x8 | 1 |
| 68 | 99.3067.00 | Vite M8x25 UNI 5739 | 4 |
| 69 | 96.7014.00 | Rosetta Ø 8.4x13x0.8 | 4 |
| 70 | 99.1912.00 | Vite M6x30 UNI 5931 | 4 |
| 71 | 96.6938.00 | Rosetta Ø 6.4x10x0.7 | 4 |

KERRICK

SERIE 63